

# For Lease

# 359 METTY DRIVE, Suite 2

SCIO TWP, ANN ARBOR, MICHIGAN

## 2,000 sf office

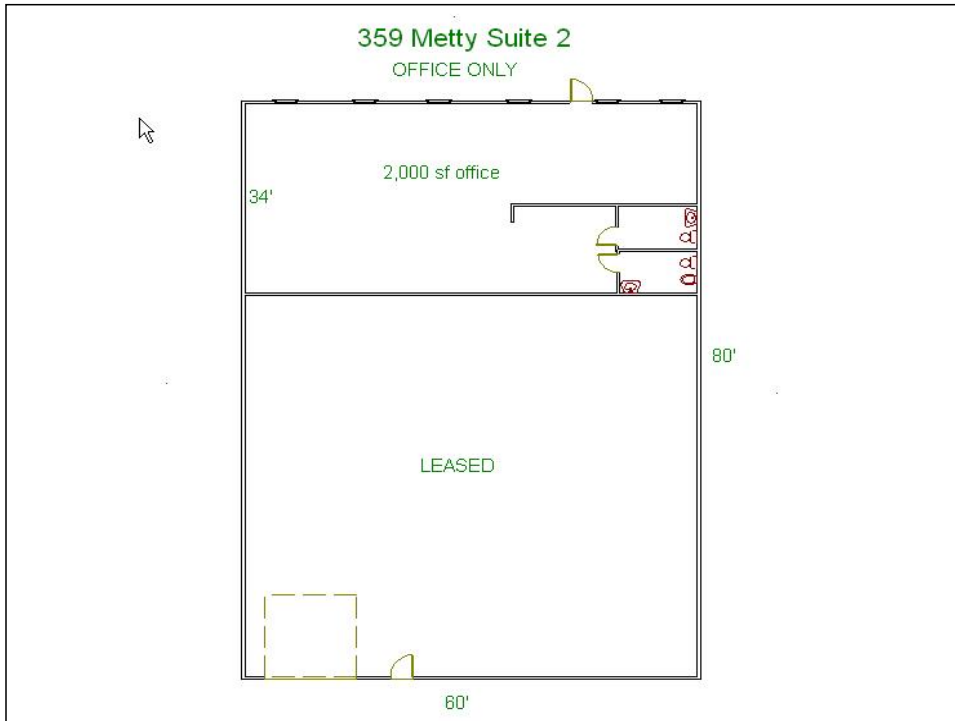

**LOCATION:** Conveniently located in Scio Commerce Center, off Jackson Avenue between Baker and Zeeb. Easy access to I-94 and M-14 with close proximity to US-23. Ann Arbor address with township taxes!

**BUILDING:** 2,000 sf of office space in excellent condition. Includes 2 restrooms and a nice open work area with high ceilings, windows to the front. Front door parking.

**ZONING:** I-1, Light Industrial, Scio Township, 734-665-2123

**PARKING:** Ample at-the-door parking.

**LEASE TERMS:** 36 months

**LEASE PRICE:** \$8.00/sf plus utilities

Rent is \$1,333/month plus utilities

Contact: **John Evans**  
**David Hamilton, CCIM**

direct: 734-662-3682  
direct: 734-662-3745

[evans@swishercommercial.com](mailto:evans@swishercommercial.com)  
[daveh@swishercommercial.com](mailto:daveh@swishercommercial.com)

Building relationships.



208 East Washington St. Ann Arbor, MI 48104  
tel: 734.663.0501 fax: 734.663.0316  
[www.swishercommercial.com](http://www.swishercommercial.com)